

D series touch panel



D5



1. Technical Specs:

- Input Voltage: DC12V-24V
- Output Signal: DMX512
- Control Mode: 4 Zones Control
- Working Temperature: -20°C~60°C
- Dimensions: L86×W86×H36(mm)
- Package Size: L113×W112×H50(mm)
- Weight(G.W.): 208g

2. Installation Instruction:

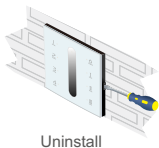
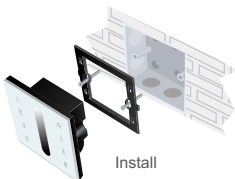

3. Key Functions:

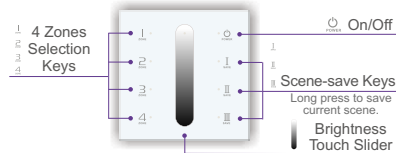

* Long press to turn on/off the tone.

4. Terminals:

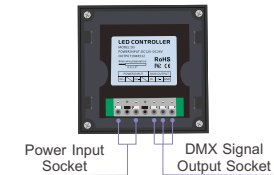

5. Wiring Diagram:

